

GENERAL NOTES:

- REFER TO SHEETS L1.0 AND L2.0 FOR TREE PROTECTION PLAN.
- PERMANENT CHAIN LINK FENCING NOT SHOWN ON THIS SHEET.

LEGEND:

- EX STRUCTURE OR HARD SURFACE TO BE REMOVED
- PROJECT WORK LIMITS
- SILT FENCING
- HIGH VISIBILITY FENCING
- WETLAND BUFFER
- 100-YEAR FLOODPLAIN
- DEBRIS BOOM **T6 C6.2**
- STRAW WATTLES
- EX TREE TO BE REMOVED

KEY NOTES:

KEY	NOTE:
①	TO REMAIN
②	TO BE REMOVED
③	SALVAGE

90% SUBMITTAL
NOT FOR CONSTRUCTION

M M
MOTT MACDONALD

9706 4TH AVE NE
SUITE 300
SEATTLE, WA 98115

P: 206.523.0024
WWW.DCGENR.COM

.TIFF-Logo_2_5W.tif

j.a. brennan
associates PLLC
Landscape Architects & Planners

2701 First Avenue, Suite 510
Seattle, WA 98121
t. 206.583.0620
f. 206.583.0623

Client







Rev	Date	Drawn	Description	Ch'k'd	App'd
0	3/20/20	GS	60% Design Drawings	WZ	SR

Project Number	353381	B/O	9	Total	101
----------------	--------	-----	---	-------	-----

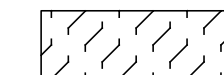
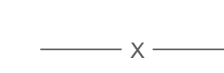
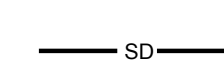
Designed	W. Zweig	Eng check	S. Robert
Drawn	G. Szoboszlai	Coordination	N. Alexander
Dwg check	N. Alexander	Approved	S. Robert
Scale at ANSI D	Status	Rev	Security
1" = 30'			
Drawing Number	G9.0		

Title
City of Kenmore
Squires Landing Park
Waterfront Improvement Project
TESC And Demolition Plan

LEGEND:

-  SHEET FLOWPATH
-  PERMANENT 6' CHAIN LINK FENCE
-  STORM DRAIN PIPE W/ TRENCHING PER: A
L18
-  WATER PIPE (SEE UTILITY PLANS)
-  SANITARY SEWER PIPE (SEE UTILITY PLANS)
-  TYPE 1 CATCH BASIN D1 & D2
C4.2
-  TYPE 1P CATCH BASIN D3
C4.2
-  FLOW PATH

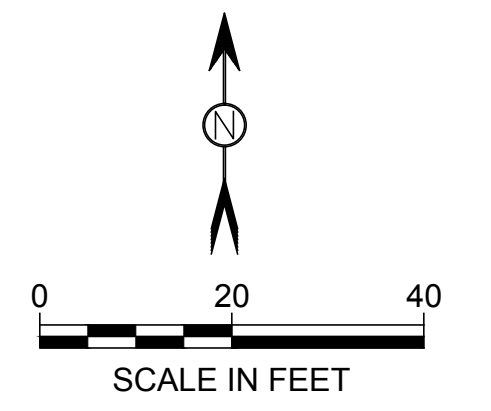

GENERAL NOTES:

1. SEE UTILITY PLANS FOR WATER AND SEWER DESIGN.
2. ALL PROPOSED SD PIPES WITH LESS THAN 2'-0" OF COVER SHALL BE SCHEDULE 80 PVC OR SDR-35.

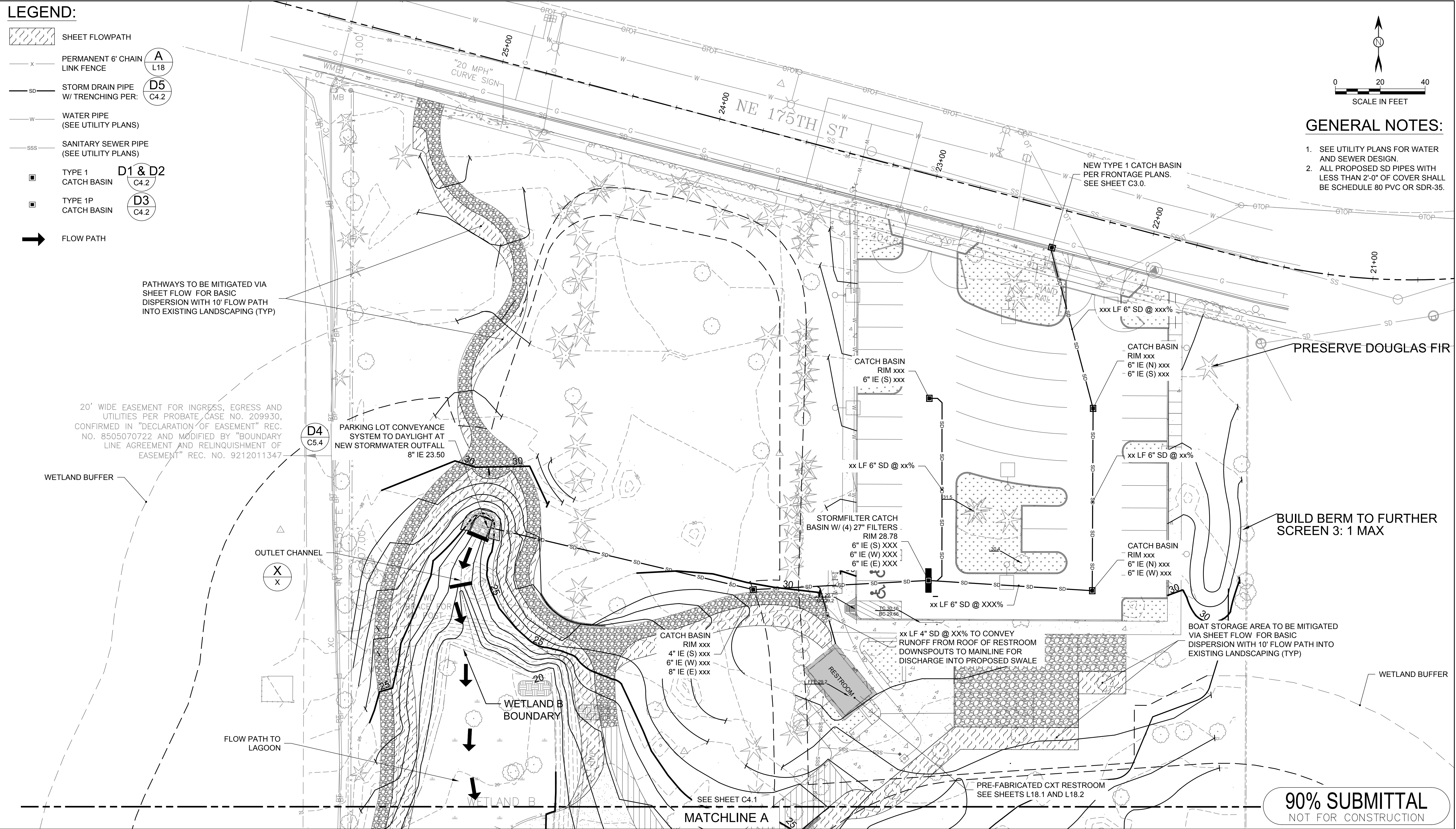

90% SUBMITTAL
NOT FOR CONSTRUCTION



Rev	Date	Drawn	Description	Ch'k'd	App'd
0	12/13/19	GS	60% Design Drawings	WZ	SR

Project Number	353381	B/O	27	Total	96
----------------	--------	-----	----	-------	----

Designed	W. Zweig	Eng check	S. Robert
Drawn	G. Szoboszlai	Coordination	N. Alexander
Dwg check	N. Alexander	Approved	S. Robert
Scale at ANSI D	Status	Rev	Security
1" = 20'			
Drawing Number	C4.0		

City of Kenmore
Squires Landing Park
Waterfront Improvement Project
Drainage Control Plan 1

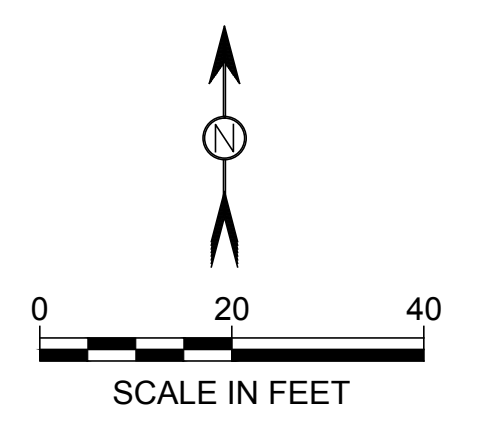
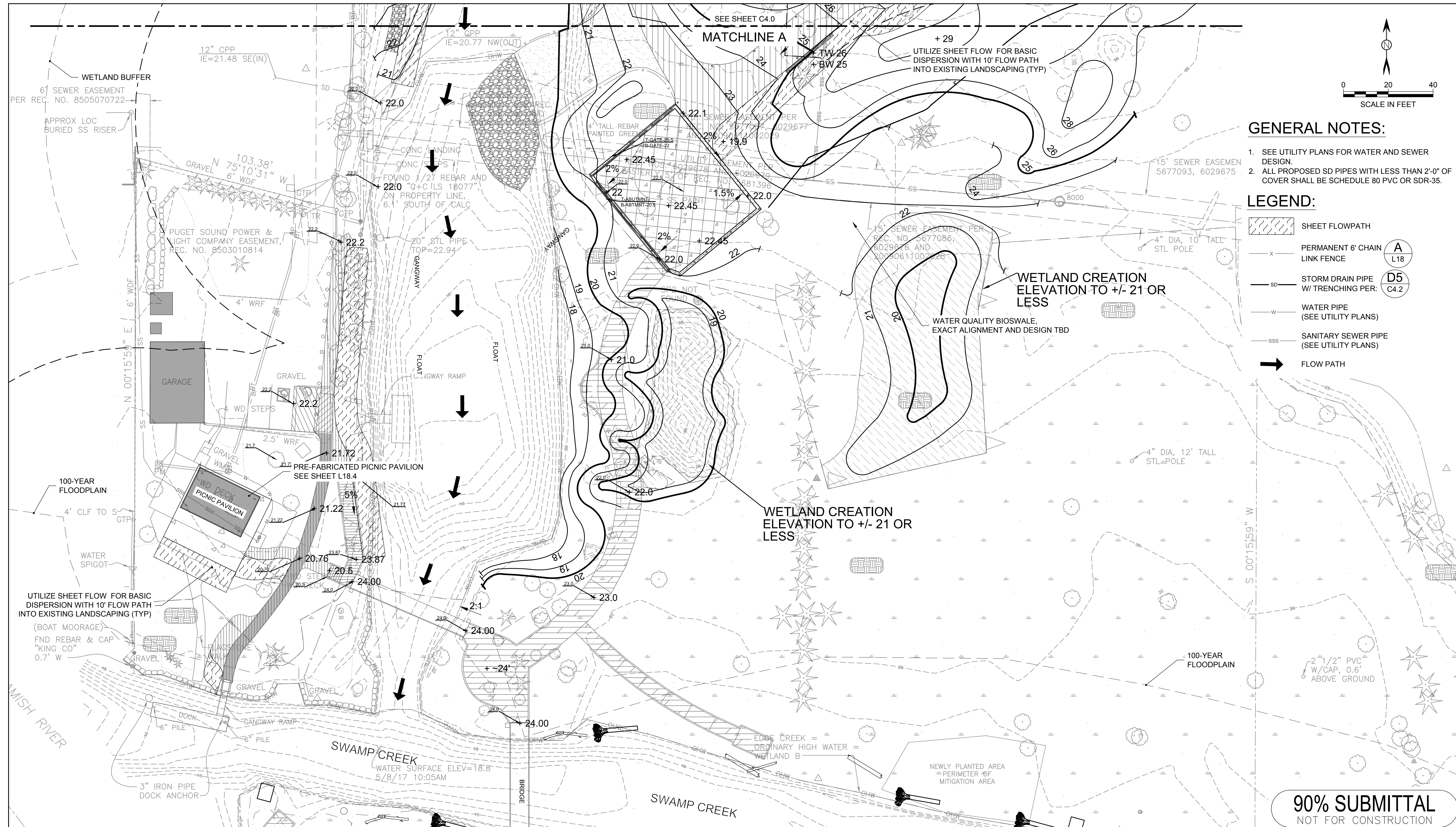

- GENERAL NOTES:**
- SEE UTILITY PLANS FOR WATER AND SEWER DESIGN.
 - ALL PROPOSED SD PIPES WITH LESS THAN 2'-0" OF COVER SHALL BE SCHEDULE 80 PVC OR SDR-35.

- LEGEND:**
- SHEET FLOWPATH
 - PERMANENT 6' CHAIN LINK FENCE
 - STORM DRAIN PIPE W/ TRENCHING PER: **D5** **C4.2**
 - WATER PIPE (SEE UTILITY PLANS)
 - SANITARY SEWER PIPE (SEE UTILITY PLANS)
 - FLOW PATH

90% SUBMITTAL
NOT FOR CONSTRUCTION



j.a. brennan
associates PLLC
2701 First Avenue, Suite 510
Seattle, WA 98121
t. 206.583.0620
f. 206.583.0623



Rev	Date	Drawn	Description	Ch'k'd	App'd
0	12/13/19	GS	60% Design Drawings	WZ	SR

Project Number	353381	B/O	28	Total	96
----------------	--------	-----	----	-------	----

Designed	W. Zweig	Eng check	S. Robert
Drawn	G. Szoboszlai	Coordination	N. Alexander
Dwg check	N. Alexander	Approved	S. Robert
Scale at ANSI D	Status	Rev	Security
1" = 20'			
Drawing Number	C4.1		

Title
City of Kenmore
Squires Landing Park
Waterfront Improvement Project
Drainage Control Plan 2