

<p>Proposed: Dredge Approx. 800 CY of Material; 215 CY clean backfill</p>	<p>Proposed Dredging Site Location</p>	<p>Applicant: Glacier Northwest 6423 N.E. 175th St, Kenmore Waterway: Lake Washington Sec.11 26T. 4E R.</p>
--	---	---

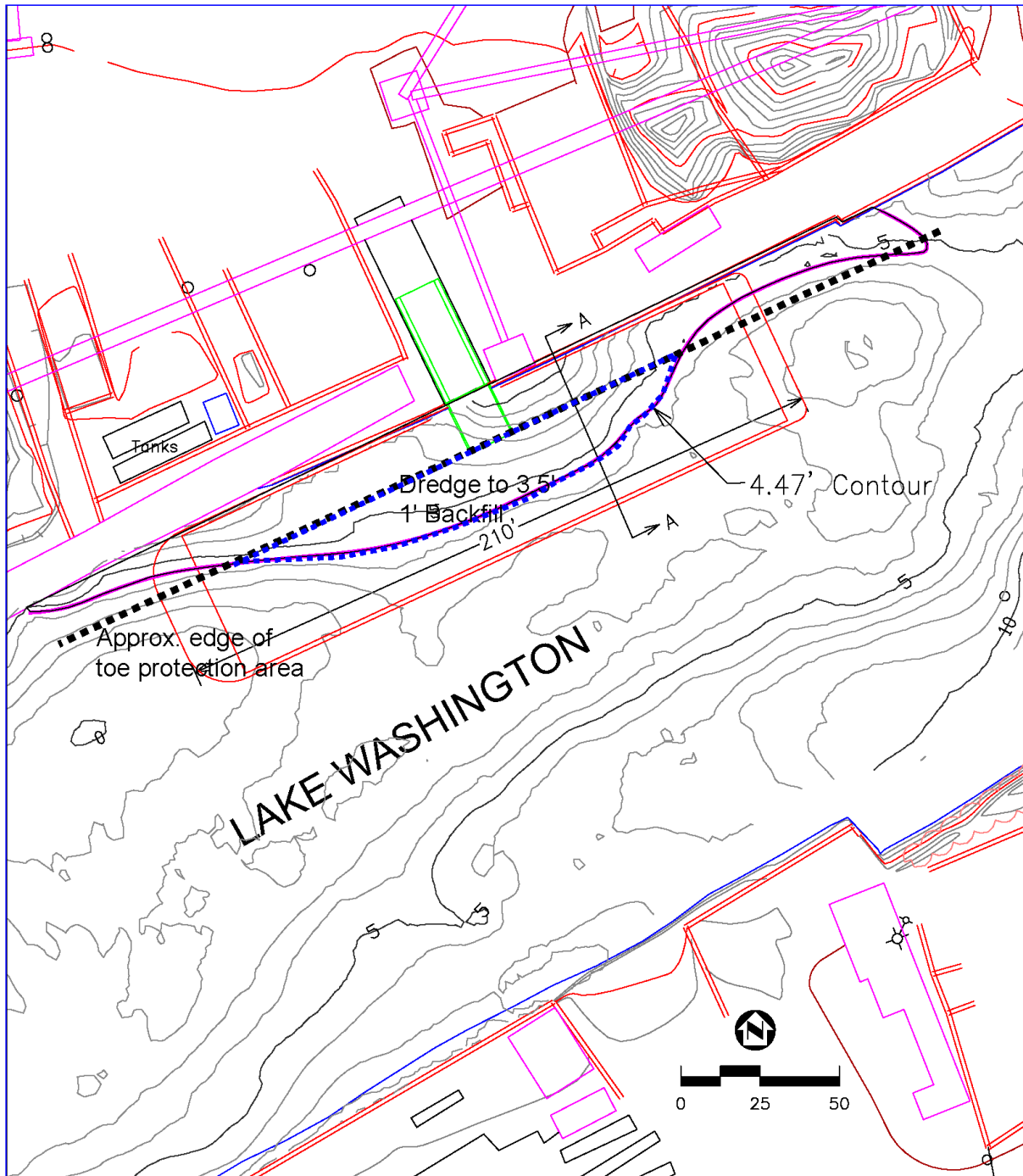

<p>Proposed: Dredge Approx. 800 CY of Material; 215 CY backfill</p> <p>Vertical Datum: Corps of Engineers Lake Washington Datum</p>	<p>Proposed Dredging Plan View</p>	<p>Applicant: Glacier Northwest 6423 N.E. 175th St, Kenmore</p> <p>Waterway: Lake Washington Sec.11 26T. 4E R.</p>
---	---	--

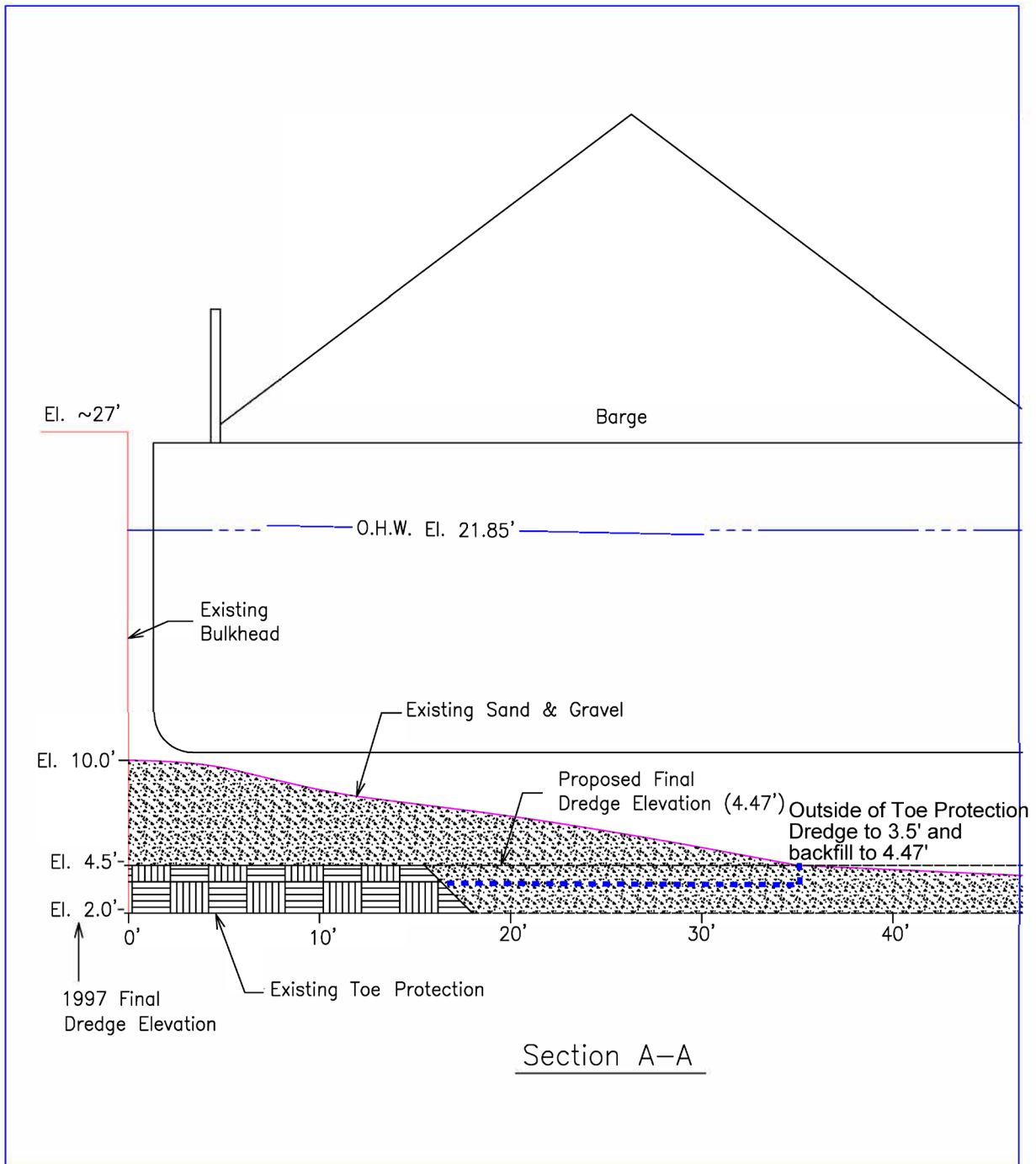

<p>Proposed: Dredge Approx. 800 CY of Material; 215 CY backfill</p> <p>Vertical Datum: Corps of Engineers Lake Washington Datum</p>	<p>Proposed Dredging Elevation View</p>	<p>Applicant: Glacier Northwest 6423 N.E. 175th St, Kenmore</p> <p>Waterway: Lake Washington Sec.11 26T. 4E R.</p>
---	--	--



**Figure 3
Elevation View**