

NOT INCLUDED IN C.S.D.P.

SR 522

SR 522

NOTE:
HEIGHTS ARE FROM
AVERAGE FINISHED
GRADE

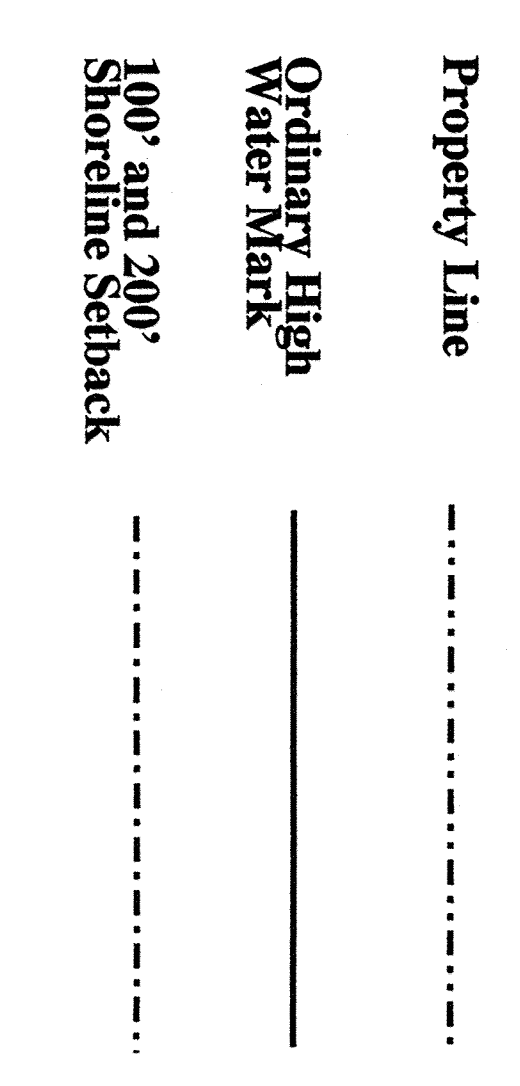
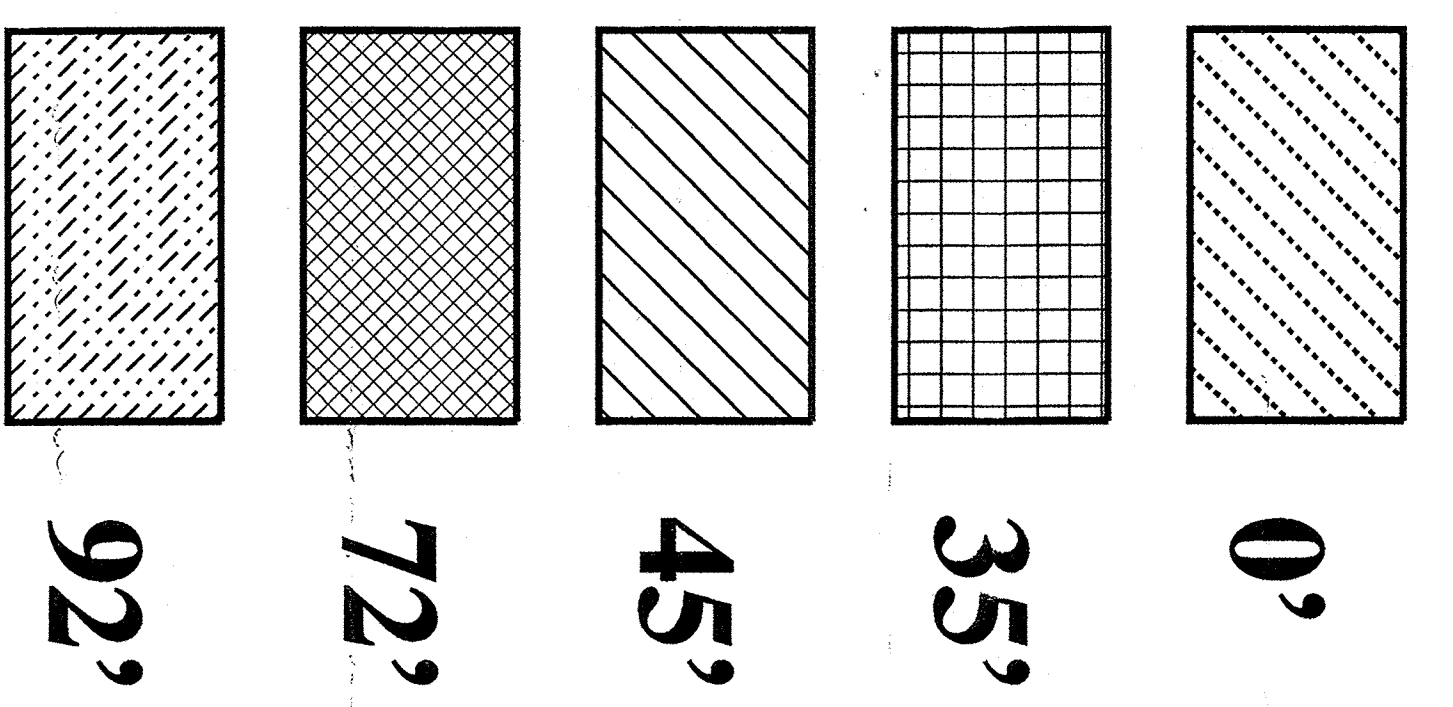

"NO SITE DISTURBANCE OR CONSTRUCTION IS AUTHORIZED UNDER THIS PERMIT"

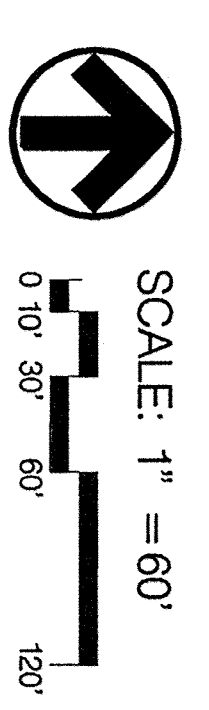

COMPILED BY: KENMORE ARCHITECTURE, INC.

Commercial Building Permit
Site Zoning Approval Only
Signed: *Richard H. Johnson*
Date: *May 28, 1998*

REVISION

LAKEPOINTE DEVELOPMENT

PIONEER TOWING COMPANY

KENMORE, WASHINGTON

Callison Architecture, Inc.
1420 5th Ave., #2400
Seattle, WA 98101-2343
T 206-623-4646
F 206-623-4625

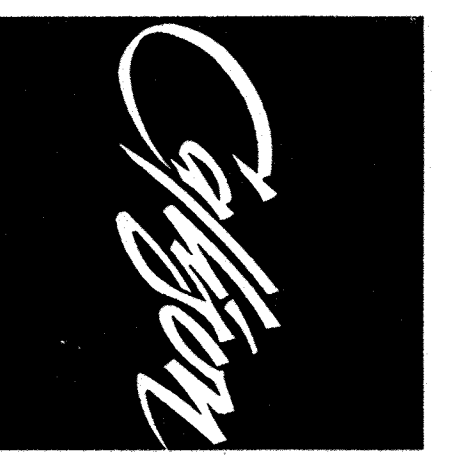

ARCHITECTURE

- First Submittal: March 26, 1996
- Second Submittal: July 15, 1996
- Third Submittal: December 23, 1996
- Fourth Submittal: January 16, 1998
- Fifth Submittal: April 20, 1998
- Sixth Submittal: May 22, 1998

Commercial Site Development Permit ENVELOPE CRITERIA PROPOSED

Project Number 95255-00

A2.6